



Affiliated With



INTERNATIONAL  
SAILING  
ASSOCIATION

## BASIC COASTAL CRUISING SAILING EXAMINATION

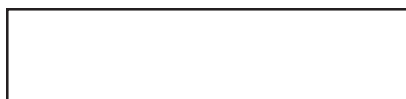

IMPORTANT - READ PRIOR TO OPENING THIS BOOKLET

IF THIS EXAM IS BEING TAKEN OUTSIDE AN ASA AFFILIATED SAILING SCHOOL IT IS AUTOMATICALLY INVALID. CONTACT THE ASA IMMEDIATELY AT (310) 822-7171

One examination booklet is assigned each candidate. An *original numbered* examination booklet is required to obtain your certification. If this booklet is not an original or has been used, STOP and contact your instructor for a new booklet. Otherwise, complete all candidate information on the front and back covers - then *wait for your instructor to advise you before opening this booklet.*

*CANDIDATE INFORMATION - (PLEASE PRINT)*

NAME \_\_\_\_\_ DATE \_\_\_\_\_

NAME OF INSTRUCTIONAL FACILITY \_\_\_\_\_

NAME OF INSTRUCTOR \_\_\_\_\_

©1987 American Sailing Association T-103 Revised 3/27/04  
5301 Beethoven Street, Suite #265, Los Angeles, CA 90066 (310) 822-7171

## INSTRUCTIONS FOR TAKING THIS EXAMINATION

1. This examination is a requirement for Certification to the Basic Coastal Cruising Standard. Your examination consists of two parts: Part A - Written Examination of Sailing Knowledge; Part B - Examination of Sailing Skills. Both parts must be satisfactorily completed prior to awarding your Certification. If there is a delay in your completing one of the two parts, the remaining part must be fully completed within 12 months of the date the first part was undertaken.
2. In Part A there are 41 questions for you to answer. Question 39 may be answered using a reference such as Chart No. 1 or other appropriate text. Questions 40 and 41 are discussion questions and will only be graded negatively if they are not answered. Part B contains 36 items of boat handling skills for you to demonstrate to your Instructor. He or she will place a checkmark in the appropriate box when you have satisfactorily performed the task required. To achieve Certification you must attain a passing score of at least 80% on Part A and 100% on Part B. In Part A read each word of each question carefully, take your time and use your best judgment in choosing the correct answer(s). In Part B you will be expected to demonstrate your best boat handling skills in each of the categories. Your Instructor will advise you in advance of how much time is allowed for you to complete each part.
3. To enhance your educational experience *you are entitled to review the questions and your answers with the Instructor*. If you choose to do so, inform your Instructor so that a mutually convenient time can be arranged.
4. Should you be unsuccessful in passing either or both parts of your Examination you may arrange for retesting. Consult your Instructor for details.

**Part A: EXAMINATION OF SAILING KNOWLEDGE  
(ASHORE KNOWLEDGE)**

Place or circle your answer in the column located on the outer margin of each page.  
Some multiple choice questions have more than one answer.

**Question 1:** Identify the following parts of a sailboat in the diagrams below.

**Question 1:**

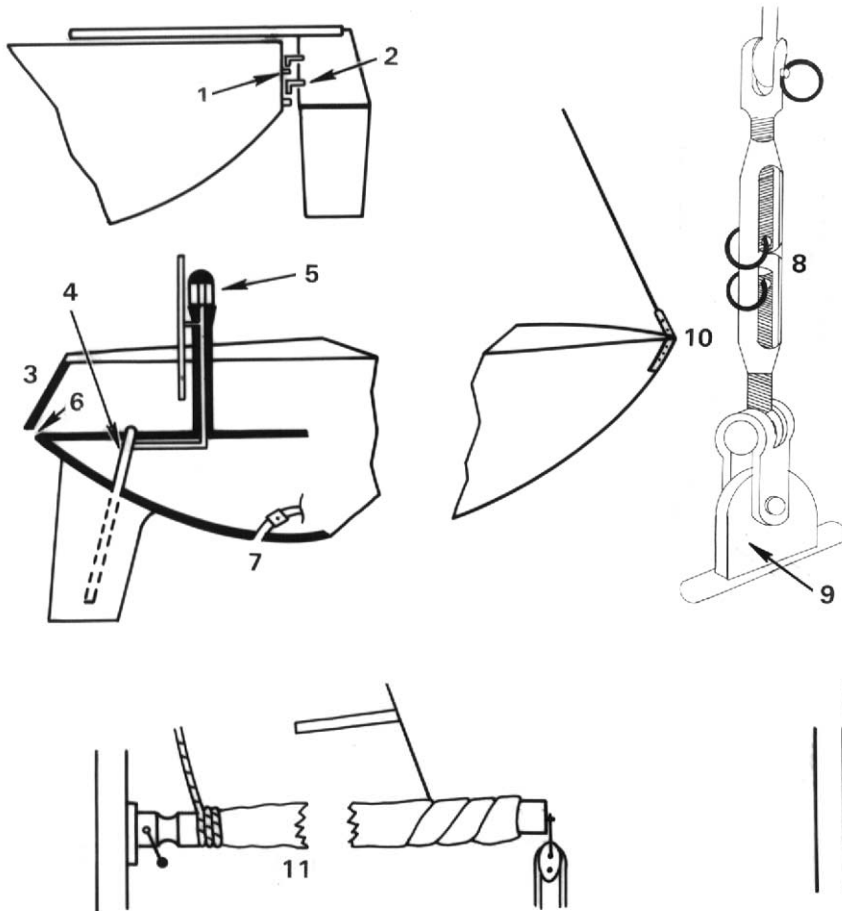

Turnbuckle.....  
Gudgeon.....  
Pintle.....  
Chainplate.....  
Rudderpost.....  
Roller Reefing.....  
Binnacle.....  
Stem Fitting.....  
Jiffy/slab Reefing.....  
Transom.....  
Through-hull Fitting.....  
Self-bailing Cockpit Drain.....

**Question 2:** The following are good reasons for keeping gear and equipment correctly stowed. Indicate the TWO most important safety reasons.

**Question 2:**

- Dry provisions are protected from bilge water
- Keep the center of gravity as low as possible
- Reduce dangers of gear flying around
- To keep the boat tidy and clean
- Equipment can be found quickly during an emergency and will function properly
- Make most efficient use of available space

\_\_\_\_\_  
\_\_\_\_\_

**Question 3:** Indicate the most important reason for a Safety Harness.

**Question 3:**

- To help keep a person standing on deck
- To help keep a person attached to the boat
- To help keep a person's head above water

\_\_\_\_\_

**Page 2**

**Question 4:** Organize the following items into two categories. Column (A) should be federal requirements and Column (B) ASA recommended safety equipment. The boat is a 27 foot sailboat which may be sailed at night and has an outboard motor with a portable fuel tank under the cockpit seat. The boat may be sailed on extended passages in poor weather. Write each letter under column A or B.

**Column**  
**A      B**

- |       |       |   |
|-------|-------|---|
| _____ | _____ | a. Two anchors with at least 200' of rode                     |
| _____ | _____ | b. USCG Approved PFD Type I, II or III for each person aboard |
| _____ | _____ | c. State registration numbers on the hull                     |
| _____ | _____ | d. Copy of a local chart                                      |
| _____ | _____ | e. Workable navigation lights                                 |
| _____ | _____ | f. Day visual distress signals                                |
| _____ | _____ | g. Sound making device  |
| _____ | _____ | h. Night visual distress signals                              |
| _____ | _____ | i. A VHF radio  |
| _____ | _____ | j. Safety harnesses   |
| _____ | _____ | k. A workable compass   |
| _____ | _____ | l. First aid kit  |
| _____ | _____ | m. One Type IV PFD  |
| _____ | _____ | n. Bailer or manual bilge pump                                |
| _____ | _____ | o. Flashlight with extra batteries and bulbs                  |
| _____ | _____ | p. Tool kit and spare parts                                   |
| _____ | _____ | q. Fire extinguisher, 2 Type B-I or 1 Type B-II               |
| _____ | _____ | r. Soft wood plugs  |

**Question 5:** Indicate the correct description of a “safety line” or a “jack line”.

- |       |   |
|-------|---|
| _____ | a. A line attached at one end to a safety harness and the other end to a secure fitting |
| _____ | b. A line running from the bow to the stern to which one can firmly hold                |
| _____ | c. A secure line running from the bow to the cockpit to which one attaches a tether     |

**Question 6:** Indicate the reason for bow and stern pulpits and lifelines.

- |       |  |
|-------|--|
| _____ | a. To help keep a person on the deck of a boat   |
| _____ | b. To decrease collision damage                  |
| _____ | c. To provide a place for people to sit or stand |

**Question 7:** Indicate whether or not the following can seriously affect the accuracy of your compass when placed directly beside it. Answer always (A), never (N) or some types (S).

- |                     |                      |
|---------------------|----------------------|
| <b>a. A   N   S</b> | a. Iron              |
| <b>b. A   N   S</b> | b. Aluminum          |
| <b>c. A   N   S</b> | c. Electrical fields |
| <b>d. A   N   S</b> | d. Bronze            |
| <b>e. A   N   S</b> | e. Stainless steel   |
| <b>f. A   N   S</b> | f. Radio             |

**Question 8:** For the three situations shown below indicate (1) where the federally required navigation lights should be located and (2) the arc of visibility for that light. A number of possible combinations are correct. List only ONE correct combination for each situation.

ARC OF VISIBILITY (top of this page is toward the bow of the boat)

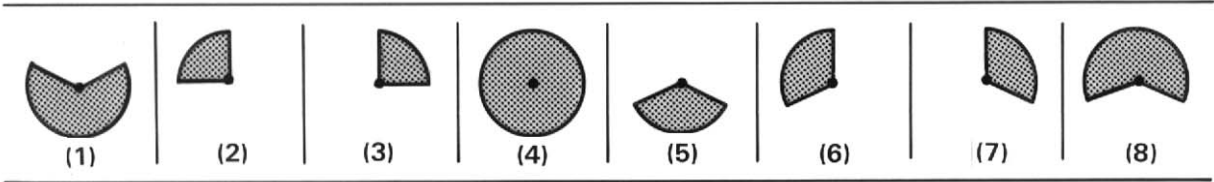

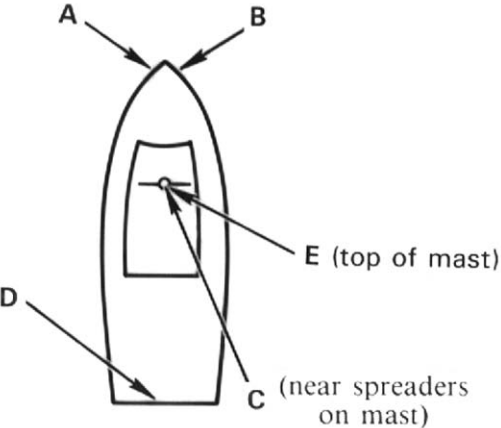
LOCATION	Location Arc	
	Use Letter	Use #
	UNDERWAY	Red Light..... _____
		Green Light..... _____
		White Light..... _____
AT ANCHOR		White Light..... _____
		Red Light..... _____
		Green Light..... _____
UNDERWAY (Power Only)		White Light..... _____
		White Light..... _____
		White Light..... _____

**Question 9:** Sailors may be required to treat hypothermia victims at some time. It is important to determine what stage the victim’s hypothermia has reached. Match the two most appropriate symptoms with each stage listed below.

SYMPTOMS

a. Loss of muscular control	Mild hypothermia	_____	_____
b. Collapse and unconsciousness			
c. Slurred speech			
d. Incoherence, drowsiness, exhaustion	Medium hypothermia	_____	_____
e. Violent shivering			
f. Respiratory distress/cardiac arrest	Severe hypothermia	_____	_____

**Question 9:**

**Question 10:** Indicate those treatments below that are recommended for a person suffering from medium hypothermia. (T=recommended, F= not recommended)

- |             |          |   |
|-------------|----------|---|
| <b>a. T</b> | <b>F</b> | a. Administer warm fluid (person is incoherent and unable to agree) |
| <b>b. T</b> | <b>F</b> | b. Administer aspirin or equivalent medication                      |
| <b>c. T</b> | <b>F</b> | c. Massage the victim's arms and legs                               |
| <b>d. T</b> | <b>F</b> | d. Elevate victim's head (person is in shock)                       |
| <b>e. T</b> | <b>F</b> | e. Administer alcohol   |
| <b>f. T</b> | <b>F</b> | f. Position victim on stomach with face to one side                 |
| <b>g. T</b> | <b>F</b> | g. Apply external, direct warmth (human body heat)                  |

**Question 11:** Which of the following actions are recommended when floating in cold water wearing a PFD and waiting for rescue? More than one answer is possible.

Circle Answer

- |           |   |
|-----------|---|
| <b>a.</b> | a. Use "drownproofing techniques"                                 |
| <b>b.</b> | b. Stay very still  |
| <b>c.</b> | c. Keep clothing on   |
| <b>d.</b> | d. Float in a fetal position (H.E.L.P.)                           |
| <b>e.</b> | e. Swim vigorously to keep warm and to draw attention to yourself |

**Question 12:** Which of the following actions is recommended for a group of people in cold water wearing PFDs and waiting for rescue? ONE answer only.

Circle Answer

- |           |  |
|-----------|--|
| <b>a.</b> | a. Hold hands for additional buoyancy              |
| <b>b.</b> | b. Huddle face to face with arms around each other |
| <b>c.</b> | c. Stay very still and watch each other            |

**Question 13:** There are a number of sources that could cause explosions/ fires on board a boat. Match fuels/gases on the left with their possible source on the right.

Place letter  
on line

FUELS/GASES

SOURCE OF FUELS/ GASES

- |       |              |                               |
|-------|--------------|-------------------------------|
| _____ | Gasoline     | a. Heating /lighting fixtures |
| _____ | Kerosene     | b. Holding tank               |
| _____ | Alcohol      | c. Inboard engine fuel tank   |
| _____ | Methane      | d. Cooking stove              |
| _____ | Hydrogen gas | e. Outboard motor fuel tank   |
| _____ | Diesel       | f. Batteries                  |

**Question 14:** Which of the following statements generally represents the recommended action to be taken to prevent fires and/or explosions?

- |       |   |
|-------|---|
| _____ | a. Enclose all areas of potential fire or explosion   |
|       | b. Ventilate all areas of potential fire or explosion |

**Question 15:** Which types of fire are the Coast Guard class Type B-I and B-II fire extinguishers designed to fight? More than one answer is possible.

TYPE OF FIRE

- a. Gasoline
- b. Oil
- c. Electrical

**Question 15:**

Circle

- a.
- b.
- c.

**Question 16:** Indicate fueling precautions recommended by the US Coast Guard when fueling a cruising sailboat with gasoline. T=recommended F=not recommended

- a. Cover and keep air away from spilled fuel
- b. Wipe or wash off spilled fuel
- c. Whenever possible, fill all portable tanks on the dock, not the boat
- d. Open all hatches & other openings before fueling
- e. Shut off all engines and motors
- f. Ventilate the bilge before turning on the engine
- g. Sniff the bilges for fuel vapors prior to starting an inboard engine
- h. Make sure vents on portable tanks have a permanently open vent cap
- i. Hold nozzle firmly against filler pipe
- j. Make sure the nozzle does not touch the filler pipe
- k. Passengers should stay aboard while fueling portable tanks on board

**Question 16:**

- a. T F
- b. T F
- c. T F
- d. T F
- e. T F
- f. T F
- g. T F
- h. T F
- i. T F
- j. T F
- k. T F

**Question 17:** Indicate TWO flag signals used in North America which signify persons are engaged in diving operations in the immediate area.

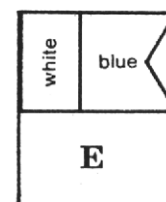
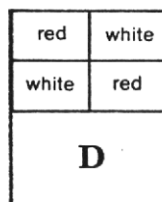
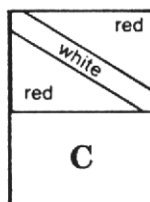
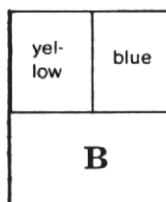
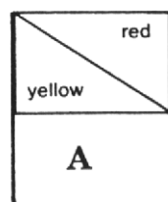

**Question 18:** Indicate those instructions commonly found on USCG Approved handheld distress signal flares. T=commonly found F=not commonly found

- a. Strap flare to stanchion or stationary object
- b. Remove tab to expose striker surface
- c. Strike ignition button against hard surface on boat
- d. Reverse top and bring striker into contact with ignition button
- e. Hold away from face, body and boat
- f. Ignite flare on the windward side of boat

**Question 18:**

- a. T F
- b. T F
- c. T F
- d. T F
- e. T F
- f. T F

**Question 19:** Which of the following conditions best describes the danger that a *lee shore* poses to your vessel?

- a. Becoming shipwrecked
- b. Losing the wind
- c. Being driven off-shore

**Question 19:**

Circle One

- a.
- b.
- c.

**Question 20:** You are at the helm of sailboat “A” and you see boat “B” approaching you on a steady bearing as pictured below.

You should:

- a. “Stand-on”  
b. “Give-way”

The reason for this is:

- c. A port tack must stay to weather  
d. A starboard tack sailboat should "give-way" to a port tack sailboat  
e. A starboard tack sailboat should “stand-on” to a port tack sailboat  
f. A leeward boat must stay clear

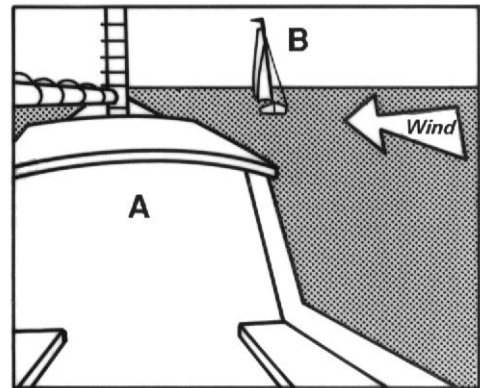

**Question 21:** You are at the helm of sailboat “A” as pictured below.

You should:

- a. “Stand-on”  
b. “Give-way”

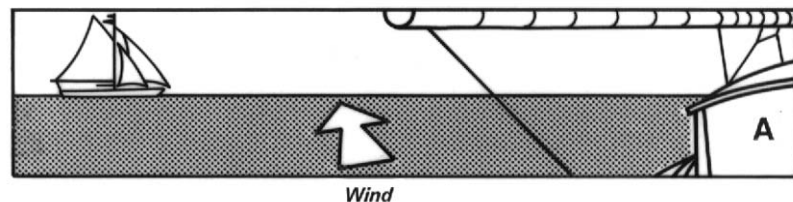

The reason for this is:

- c. A starboard tack sailboat should keep out of the way of a port tack sailboat to leeward  
d. When two sailboats have the wind on the same side the sailboat which is windward shall keep out of the way of the sailboat to leeward  
e. The leeward sailboat is the “give-way” sailboat to a starboard tack sailboat to windward  
f. A port tack sailboat shall keep out of the way of a starboard tack sailboat to leeward

**Question 22:** Using your knowledge of the USCG Navigation Rules indicate the sailboat which is free to alter her course and speed (give-way vessel) and choose the course this sailboat should take. Boats are not in imminent danger of collision.

- |    |    |
|----|----|
| A  | B  |
| 1  | 3  |
| 2  | 4  |
| C  | D  |
| 5  | 7  |
| 6  | 8  |
| E  | F  |
| 9  | 11 |
| 10 | 12 |
| G  | H  |
| 13 | 15 |
| 14 | 16 |

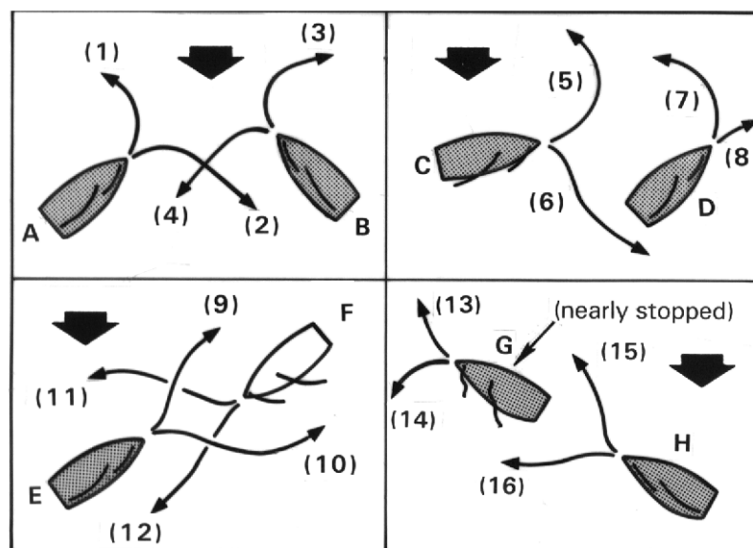

**Question 23:** Indicate those US Coast Guard required and ASA recommended procedures that are designed to reduce the danger of collision with either the shore or another boat during times of restricted visibility.

T=Required or listed by ASA F=Not required or listed by ASA

- Maintain speed and course
- Keep a lookout/ "listen out"
- A sailboat makes two long "blasts" of a horn or whistle
- Enter shipping lanes and move in the direction of the traffic
- Hoist a radar reflector
- Ensure most crew members are below and quiet so the skipper can listen
- Slow down
- Keep track of your course and distance run and plot your position on your local chart

- T F
- T F
- T F
- T F
- T F
- T F
- T F
- T F

**Question 24:** Given the following wind speeds, which sail combination is recommended for the candidate's boat, a fin keel boat about 25 feet long on a close hauled course? Match each letter with one wind speed only.

SAIL COMBINATION

WIND SPEED IN KNOTS

- |                        |       |
|------------------------|-------|
| a. Main and jib        | 0-10  |
| b. Main and genoa      | 11-16 |
| c. Reefed main only    | 17-25 |
| d. Reefed main and jib | 26+   |

**Question 24:**

**Place Letter  
on Line**

\_\_\_\_\_

\_\_\_\_\_

\_\_\_\_\_

\_\_\_\_\_

**Question 25:** The following list of responsibilities describes duties which must be performed aboard ship. In column (A) list those duties which are most appropriately assumed by the skipper and in column (B) the duties assigned to the crew.

- Safety of crew and boat
- Ensuring shipmates' knowledge of operation and location of all lifesaving and safety equipment
- Assume responsibility for a particular aspect of operation
- Assess shipmates' abilities and monitor their performance
- Assigning of duties and giving instruction if necessary
- Assisting in the safe operation of the boat
- Obedying orders

**Question 25:**

**A B**

_____	_____
_____	_____
_____	_____
_____	_____
_____	_____
_____	_____
_____	_____

**Question 26:** What units are used to measure distance on a nautical chart?

- Statute Mile
- Nautical Mile
- Kilometer

**Question 26:**

\_\_\_\_\_

**Question 27:** One Nautical Mile equals which of the following?

- One degree of Latitude
- One degree of Longitude
- One minute of Latitude
- One minute of Longitude

**Question 27:**

\_\_\_\_\_

**Question 28:** Match the following description of navigational aids with its drawing.

- DESCRIPTION
- \_\_\_\_\_ “Preferred channel”
- \_\_\_\_\_ “Safe water”
- \_\_\_\_\_ “Port side daymark”
- \_\_\_\_\_ “Starboard side daymark”



A



B



C



D

**Question 29:** Indicate the FOUR best methods used individually or in combination for freeing a small sailboat that has run aground.

- METHOD
- |   |                                    |
|---|------------------------------------|
| _____ a. Shift extra weight to the stern                | _____ e. Use anchor as a kedge     |
| _____ b. Heel boat by tying the halyard to a set anchor | _____ f. Rock boat forward and aft |
| _____ c. Hoist weight up on a halyard                   | _____ g. Sail or motor off         |
| _____ d. Request a tow                                  |                                    |

**Question 30:** Match the following uses with the knots listed.

- |                                   |  |
|-----------------------------------|--|
| <u>KNOTS</u>                      | <u>USES</u>                              |
| _____ Reef knot                   | a. For securing an unattended boat       |
| _____ Bowline                     | b. Tying 2 ropes of unequal thickness    |
| _____ Figure eight                | c. Reefing                               |
| _____ Clove hitch                 | d. Stopper knot                          |
| _____ Sheet bend                  | e. Creates non-slipping temporary loop   |
| _____ Round turn & 2 half hitches | f. Temporarily securing a line to a spar |

**Question 31:** Indicate the FOUR best features of a safe anchorage.

- |                                    |   |
|------------------------------------|---|
| _____ a. Good holding ground       | _____ e. Lack of weeds                      |
| _____ b. Good navigational aids    | _____ f. Shelter from waves and swells      |
| _____ c. Lack of other boats       | _____ g. Room to swing on the anchor        |
| _____ d. Sufficient depth of water | _____ h. High shoreline for wind protection |

**Question 32:** Which of the following reasons explains why chain is used to increase the anchor’s holding power and reliability? More than one answer may be given.

- REASONS
- |    |   |
|----|---|
| a. | a. Makes the anchor’s weight closer to that of the boat |
| b. | b. Keeps the anchor’s shank on the bottom               |
| c. | c. Keeps the rode from chafing                          |
| d. | d. Acts as shock absorber                               |
| e. | e. Is USCG required                                     |

**Question 33:** You are entering an unfamiliar harbor below. The navigation aids are shown (R=red G=green). Indicate which path or paths represent safe passage into the harbor. More than one answer may be correct.

**Question 33:**

A  
B  
C  
D  
E  
F

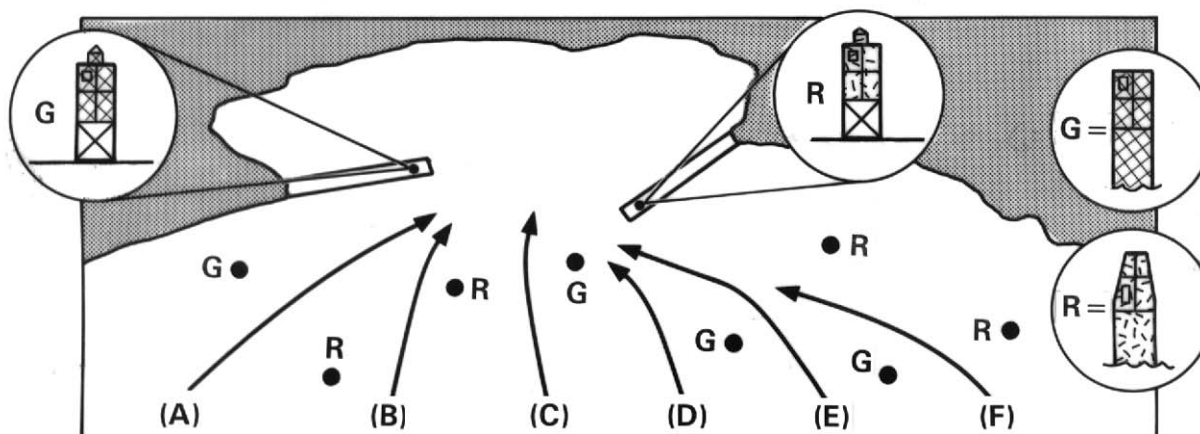

**Question 34:** You are entering a channel from seaward that has a fork. Choose the path to safely navigate the preferred channel (R=red G=green W=white.) Only **ONE** answer is correct.

**Question 34:**

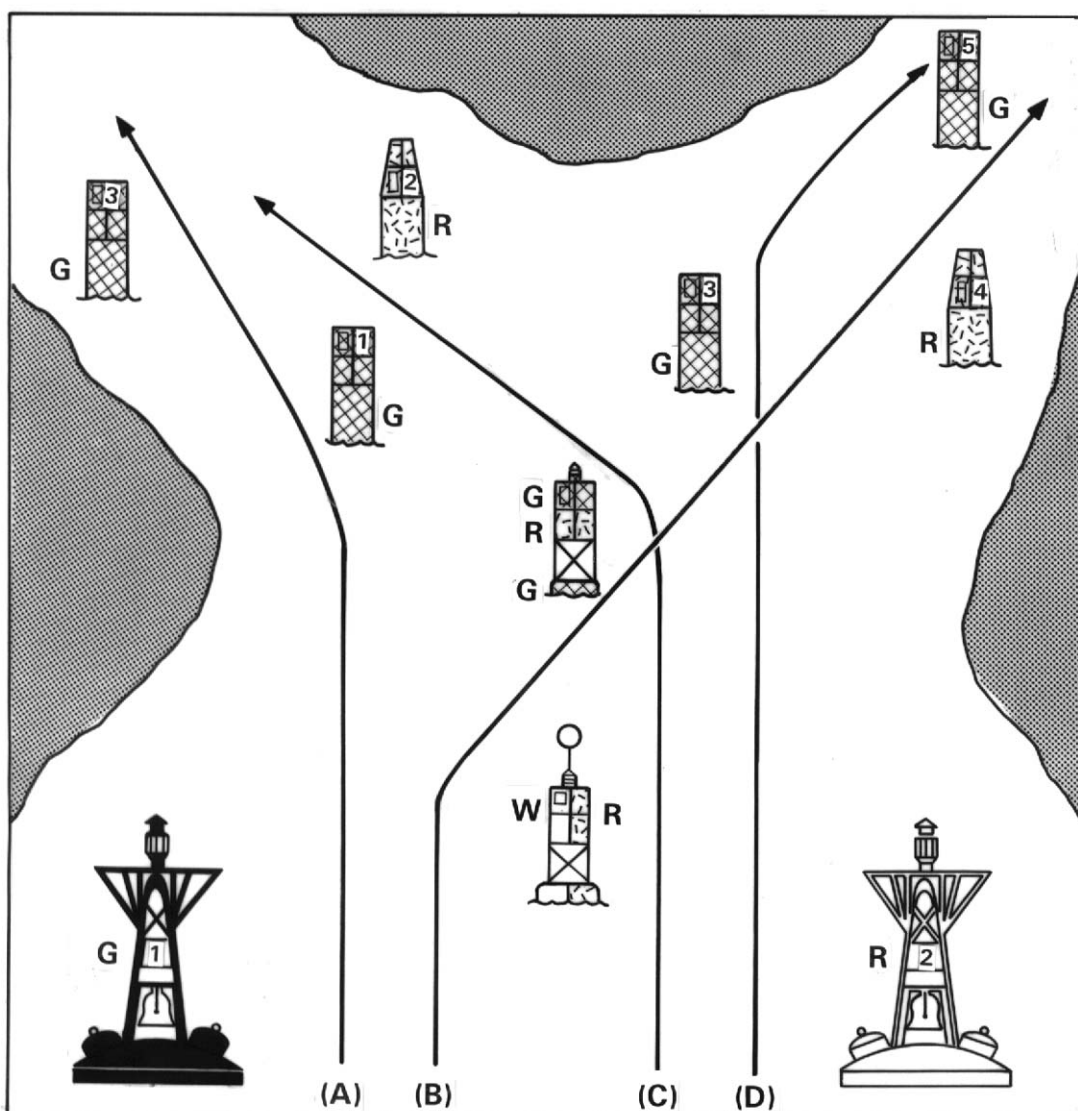

**Question 35:** Indicate the single BEST IMMEDIATE ACTION for each situation listed below.

<u>SITUATION</u>	<u>IMMEDIATE ACTION</u>
_____ Spring a leak	a. Radio for help b. Determine source & extent of problem c. Alter course for home port
_____ Rigging Fails	a. Start engine b. Drop sails c. Position the boat to reduce strain on mast
_____ Steering fails	a. Determine other control method b. Get PFDs on crew c. Radio for help
_____ Dragging anchor	a. Increase scope b. Motor in reverse c. Set a second anchor
_____ Grounding at anchor	a. Motor toward anchor b. Increase scope c. Consult the chart & tide tables
_____ Running hard aground on a beam reach	a. Turn away from shore b. Ease sheets c. Motor in reverse
_____ Foul propeller	a. Pull on fouling line b. Cut fouling line c. Stop engine
_____ Broken halyard	a. Tack b. Secure sail c. Rig another halyard

**Question 36:** Which phrase below describes a quality which makes an anchor effective on a pleasure craft?

- \_\_\_\_\_ a. enough weight to sit immovably on the bottom  
b. a design which allows for burial of its flukes

**Question 37:** When anchoring in 25 feet of water (at highest tide) on a sandy bottom with a proper sized Danforth type anchor, which rode length(s) would be inadequate for secure overnight holding?

- a.      b.      c.      d.  
a. 220'      b. 115'      c. 75'      d. 190'

**Question 38:** On a boat that is equipped with a danforth and a plough anchor, which would you prefer in each of the following types of bottom?

**Question 38:**

ANCHOR

- a. Danforth  
b. Plough

DESCRIPTION

Soft mud.....	_____
Rocky.....	_____
Sandy.....	_____
Hard mud.....	_____
Weeds.....	_____

THE FOLLOWING QUESTION MAY BE ANSWERED USING A REFERENCE LIKE CHART NO.1. IT WILL BE GRADED FOR POINTS.

**Question 39:** Indicate the best term/ description for the symbols/ abbreviations used on charts published by the United States. Only one correct answer for each symbol/ abbreviation.

**Question 39:**

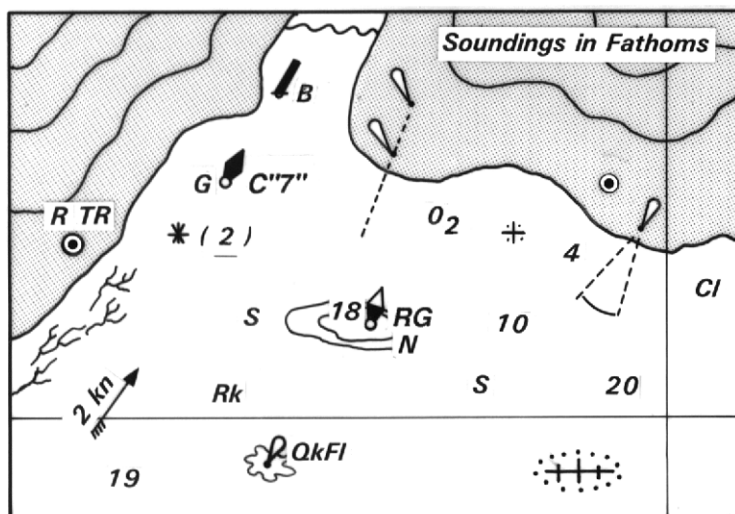

A

⊙ R TR	
QkFI	
⊕	
⊕	
⚓ B	
Cl	
( 2 )	
2 kn	

B

⚓	
0 <sub>2</sub>	
⚓	
Rk	
⚓	
⚓ C'7"	
⚓ RG N	

TERMS/DESCRIPTIONS

- |  |                          |                        |
|--|--------------------------|------------------------|
| a. 2 ft. sounding                                | b. 4 fathom sounding     | c. Kelp                |
| d. Wreck (sunken)                                | e. Transit/range         | f. Light               |
| g. Reserved buoy                                 | h. Underwater cable      | i. Chimney             |
| j. Changing light                                | k. Wreck                 | l. Clay bottom         |
| m. Spar buoy-black                               | n. Flood stream, 2 knots | o. Can buoy            |
| p. Quick flashing                                | q. 2 knot speed limit    | r. Sector light        |
| s. Covers/uncovers at 2 foot height above datum  |                          | t. Radio tower         |
| u. Covers /uncovers at 2 foot height below datum |                          | v. Nun buoy (junction) |
| w. Rock awash at datum of sounding               |                          | x. Rocky bottom        |

QUESTIONS 40 AND 41 ARE DISCUSSION QUESTIONS. POINTS WILL ONLY BE SUBTRACTED FROM A CANDIDATE'S SCORE IF ANSWERS ARE LEFT BLANK.

**Question 40:** Given the following wind directions in your area (N.S.E.W.), indicate the highest wind speed advisable in which to go sailing and what wave heights to expect. Also indicate if a *lee shore* danger exists. Answers are to relate to local conditions and will be judged correct or incorrect by your ASA Instructor.

Answer wind speed in **miles per hour** Answer wave height in feet

Answer **lee shore** condition: T=True (condition exists) F=False(condition does not exist)

North Wind

Highest speed \_\_\_\_\_

Wave height \_\_\_\_\_

Lee shore? \_\_\_\_\_

South Wind

Highest speed \_\_\_\_\_

Wave height \_\_\_\_\_

Lee shore? \_\_\_\_\_

East Wind

Highest speed \_\_\_\_\_

Wave height \_\_\_\_\_

Lee shore? \_\_\_\_\_

West Wind

Highest speed \_\_\_\_\_

Wave height \_\_\_\_\_

Lee shore? \_\_\_\_\_

**Question 41:** Name **THREE** local weather hazards, how they can be identified by actual observation and the warning time between the observation and the arrival of the hazard. Answers are to relate to local conditions and are to be judged correct or incorrect by your ASA Instructor.

1. Hazard \_\_\_\_\_

Observation \_\_\_\_\_

Warning time \_\_\_\_\_

3. Hazard \_\_\_\_\_

Observation \_\_\_\_\_

Warning time \_\_\_\_\_

2. Hazard \_\_\_\_\_

Observation \_\_\_\_\_

Warning time \_\_\_\_\_

**CANDIDATE INFORMATION:**  
(PRINT CLEARLY)

Examination # \_\_\_\_\_ (from front cover)

Name: \_\_\_\_\_ (last) \_\_\_\_\_ (first) \_\_\_\_\_ (initial)

Address: \_\_\_\_\_ (street) \_\_\_\_\_ (city) \_\_\_\_\_ (state) \_\_\_\_\_ (zip+4)

E-mail: \_\_\_\_\_ Phone# \_\_\_\_\_

**PART B: EXAMINATION OF SAILING SKILLS**

**BASIC COASTAL CRUISING EXAMINATION**

Each of the following items must be properly performed before this examination can be considered to be satisfactorily completed. A check mark in the corresponding box below signifies that the ASA **Instructor has witnessed** the Candidate's successful performance of the sailing skills specified. All sailing skills are to be performed in moderate wind and sea conditions, demonstrating proper safety precautions.

(TO BE COMPLETED BY THE ASA INSTRUCTOR)

**PRELIMINARIES**

- ☐ 1. Demonstrate proper use of PFD.
- ☐ 2. Give verbal checklist of required and ASA recommended equipment
- ☐ 3. Produce equipment on checklist and note deficiencies, if any.
- ☐ 4. Demonstrate use and care of domestic equipment using the manufacturer's instructions.
- ☐ 5. Demonstrate safe winch techniques.
- ☐ 6. Perform the outboard checklist prior to starting.

**BOAT HANDLING UNDER POWER**

- ☐ 7. Start an auxiliary engine (outboard motor), observing ASA recommended safety procedures.
- ☐ 8. Skipper the boat to full stop, using reverse, with the bow one-half boat length away from a buoy (straight line course).
- ☐ 9. Skipper the boat under power parallel and 2' away from a dock. Approach port then starboard side to, without lines, and without passing a given mark on the dock.
- ☐ 10. Stop an auxiliary engine (outboard motor) using ASA recommended safety procedures.

**PERSON OVERBOARD:**

- ☐ 11. Demonstrate a skipper's actions/commands while under power in the proper Person Overboard procedures: alertness, life ring/marking, lookout, control of boat speed and engine.

**ANCHORING:**

- ☐ 12. Anchor in water more than ten feet in depth so as to not draft the anchor using engine at half throttle astern.
- ☐ 13. Raise anchor with boat ready to sail.

**BOAT HANDLING UNDER SAIL**

**POINTS OF SAIL:** Act as a helmsman and crew (giving proper commands and responses) while demonstrating proper techniques of:

- ☐ 14. close hauled
- ☐ 15. reaching (three kinds)
- ☐ 16. running
- ☐ 17. tacking and jibing
- ☐ 18. heading up
- ☐ 19. bearing away
- ☐ 20. luffing
- ☐ 21. reducing heel (all P of S)

**REEFING AND HEAVING TO:**

- ☐ 22. Reduce sail by reefing and shaking out the reef while under control.
- ☐ 23. Heave to and get under way again.

**PERSON OVERBOARD:**

- ☐ 24. Demonstrate a skipper's actions/commands while under sail in the proper Person Overboard procedures: alertness, life ring/marking, lookout, control of boat speed.
- ☐ 25. Describe actions if one person falls overboard and one is onboard.
- ☐ 26. Describe two methods of getting a person onboard.

**STEERING:**

- ☐ 27. Steer a compass course for 5 minutes within 10 degrees of specified course at all times.

**SECURING TO A DOCK/MOORING:**

- ☐ 28. Secure the boat to various dock configurations to prevent excessive movement and set out fenders accordingly.
- ☐ 29. Demonstrate the extra precautions to secure a boat for the night at a dock and at a mooring.

**KNOTS**

Tie the following knots in less than 15 seconds:

- ☐ 30. bowline
- ☐ 31. clove hitch
- ☐ 32. reef knot
- ☐ 33. round turn with half hitches
- ☐ 34. sheet bend

Tie the following knots in less than 7 seconds:

- ☐ 35. figure eight
- ☐ 36. cleat hitch

**REQUEST FOR OFFICIAL ASA CERTIFICATION**

(PLEASE COMPLETE FULLY AND PRINT CLEARLY)

**CANDIDATE PLEASE NOTE**

To ensure that you become officially *Certified* these steps **must** be taken:

1. Your Instructor must sign your official ASA Sailing Log Book in the appropriate section immediately upon successfully completing both parts of this Examination.
2. Your Instructor must forward this Examination to the ASA according to prescribed procedures.
3. Within 10 days of receiving your examination the ASA will mail you the *Certification Seal* which is to be affixed in your Log Book. If you do not receive your *Certification Seal* within a reasonable time after completing this Examination, usually less than 30 days, **contact your Instructor** to determine if he or she has processed your documents.

**A. TO BE COMPLETED BY CANDIDATE**

I am a current member of the ASA \_\_\_\_ yes \_\_\_\_ no; if yes give # \_\_\_\_\_

I was previously Certified to the ASA Basic Sailing Standard: \_\_\_\_ yes \_\_\_\_ no; if yes, name of facility \_\_\_\_\_

I request the following be sent to my address:

\_\_\_\_ ASA membership information \_\_\_\_ ASA Instructor Qualification Information  
\_\_\_\_ Other \_\_\_\_\_

SIGNATURE: \_\_\_\_\_ DATE \_\_\_\_\_

**B. TO BE COMPLETED BY AN ASA INSTRUCTOR**

I certify that I have personally examined this Candidate in accordance with the ASA **Basic Coastal Cruising** Standard and that he or she has been found fully proficient in both the Sailing Knowledge and Sailing Skills requirements having attained the following scores:

Knowledge \_\_\_\_ % (Pass 80%) Skills \_\_\_\_ % (Pass 100%)  
Furthermore, I have signed and dated his or her personal Log Book in the appropriate Certification space.

ASA Instructor's Name \_\_\_\_\_

Current highest level of Instructor certification \_\_\_\_\_

ASA Membership # \_\_\_\_\_ Expiration Date \_\_\_\_\_

Name of Certification Facility \_\_\_\_\_ Id# \_\_\_\_\_

Instructor's signature \_\_\_\_\_ Date \_\_\_\_\_